

TAD3 – Aquadisc 3

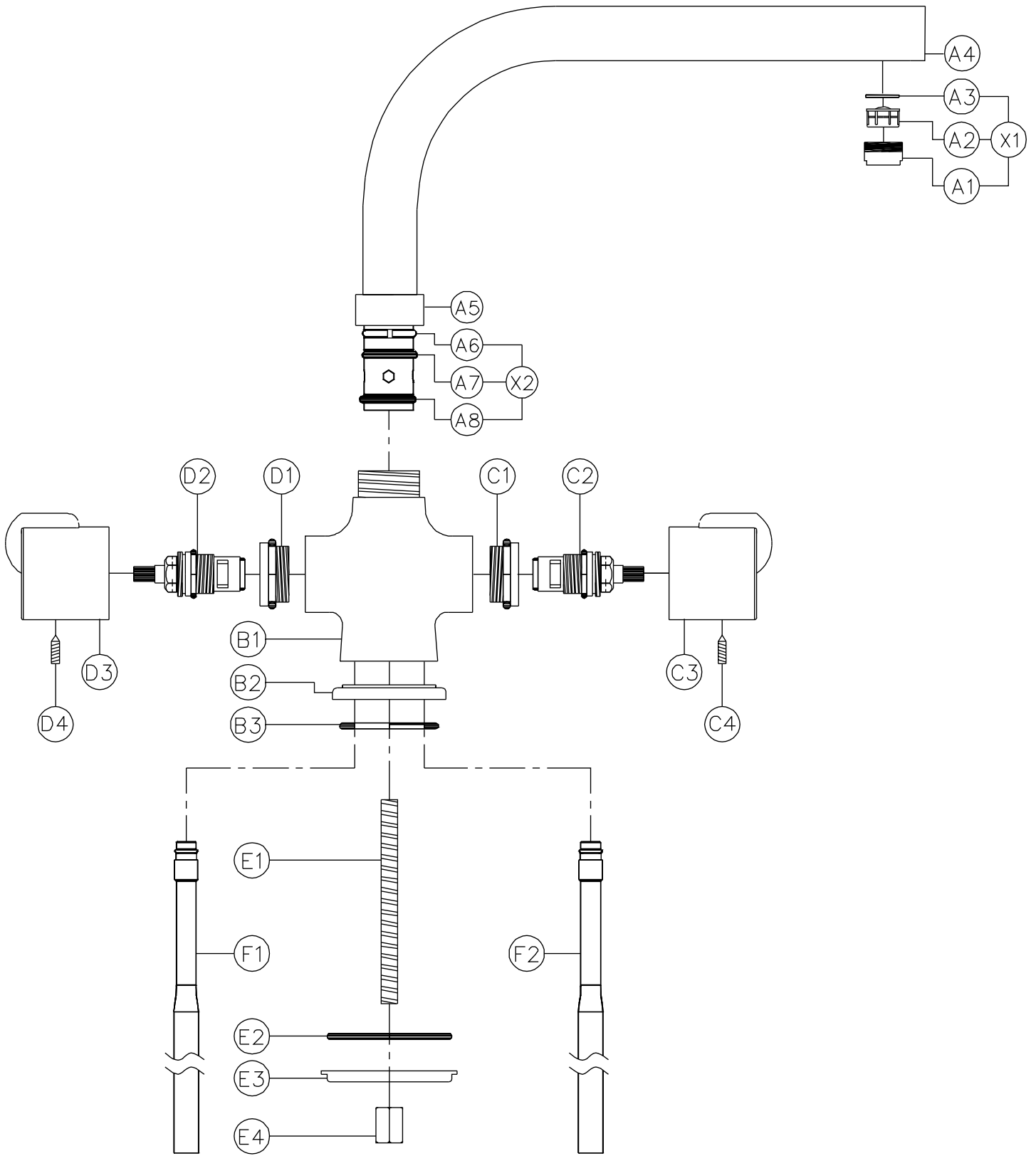

General Advice:

- These instructions are intended as a guide only, if you are in any doubt you should seek the advice of a qualified professional.
- Take care not to mark finished parts with screwdrivers or other tools.
- Use a pair of rubber gloves to get a better grip on decorative hand tight parts.
- Ensure all parts are reassembled tightly.
- After maintenance test that all assemblies are water tight and function correctly.
- Always isolate the hot and cold water supplies before starting any maintenance, once isolated you should drain any residual water from your system.

To replace the valve:

1. Loosen grub screw (C4) on handle (C3) using a 2.5mm A/F allen key.
2. Pull the handle (C3) horizontally away from the tap.
3. Hold the body of the tap (B1) firmly. Using an adjustable or 17mm ring spanner unscrew the valve (C2).
4. Clean the inside of chamber (B1) with a soft wet cloth.
5. Reassemble the tap in the reverse order.

To replace the spout o-rings:

1. Unscrew the spout lock nut (A5) by hand.
2. Pull the spout (A4) vertically away from the body (B1).
3. Remove the old o-rings (A7 & A8) using a small screwdriver or similar.
4. If worn, remove the white PTFE spacer (A6).
5. Ensure the inside of the body (B1) and the spout base (A4) is clean of dirt and grit.
6. If required locate the new white PTFE spacer (A6).
7. Carefully locate the new O-rings (A7 & A8) onto the spout (A4).
8. Grease the O-rings (A7 & A8) thoroughly with silicone or alternative similar grease.
9. Reassemble the tap in the reverse order.